

Technical rider for LOL – Maximum Set-up

ABOUT LOL

LOL is a visual and physical solo opera by OPE-N www.ope-n.dk

Trailer and full performance: https://www.youtube.com/@open_operanord

On tour: 1 performer + 2 technicians + 1 director

Duration: approx. 45 min, max 2 shows a day

THE VENUE PROVIDES

SPACE

LOL is particularly suitable for a black box, or other darked rooms.

- 83 boxes in a pattern of 8x8 squares and a total ground plan of W 12 x D 12 m
- The set-up must have a corridor of W 1.3 m all around the ground plan
- The boxes are all reinforced so the audience can sit on them. A selection of marked boxes has various functions during the show and cannot be used by the audience.
- The stage must be cleaned before get-in
- The stage must have at least one door minimum W 1.2, H 2.1 m
- Dressing room with shower and two towels
- Access to water/bucket for preparation of fake blood mixture
- Access to industrial vacuum cleaner
- Access to washing machine and dryer

SOUND

Speakers on stands surround the installation and needs no extra rigging in the venue.

- **PA equipment** (Preferably Acoustics or similar quality):
 - 2 L-Acoustics SB118 sub
 - 4 L-Acoustics X12 coax speaker passive
 - 7 L-Acoustics X12 coax speaker passive
 - 3 L-Acoustics LA4X controller amplifier w. AES.
 - 11 K&M 213 speaker stands & 5 microphones stands.
- **Signal cables**
 - 6 Speakon 10m, 6 Speakon 15 m, 6 Speakon 25 m, 6 Speakon manifold
 - Switchboards

LIGHT

The lighting set-up is attached directly to the boxes and needs no extra rigging in the venue.

- **Astera equipment:**
 - 5 HydraPanel FP6, 4 x kit, Astera
 - 1 PixelBrick 8 x kit, Astera
 - 26 Shotbags, 13,5 kg
 - 1 Asterabox ART7 CRMX, Astera

PLANNING AND STAFF

- 2 technicians for load in: 2 x 8 hours
- 2 stagehands for load out: 2 x 3 hours

Continued >

Technical rider – Maximum Set-up

THE COMPANY PROVIDES

SET DESIGN AND PROPS

- An installation of reinforced collapsible boxes, that the audience sits on.
- The maximum number of boxes allows 100 audiences.
- It is possible to scale the number of boxes according to the size of the venue – see examples below.
- A selection of marked boxes has various functions during the show and cannot be used by the audience.
- Fake blood, costume, confetti & other props

SOUND

- Computer, Q-lab, mixer, soundcards, headphones and in-ear, controller, signal cables, microphones, and stands.

VOLUME OF INSTALLATION ON ARRIVAL

The installation is brought on 3 pallets with the following measurements:

- 2 x W 1,2m x D 0,8 x H 2 m (2 x 110 lb/50 kg)
- 1 x W 1,2 m x D 1 m x H 1,4 m (1 x 220 lb/100 kg)



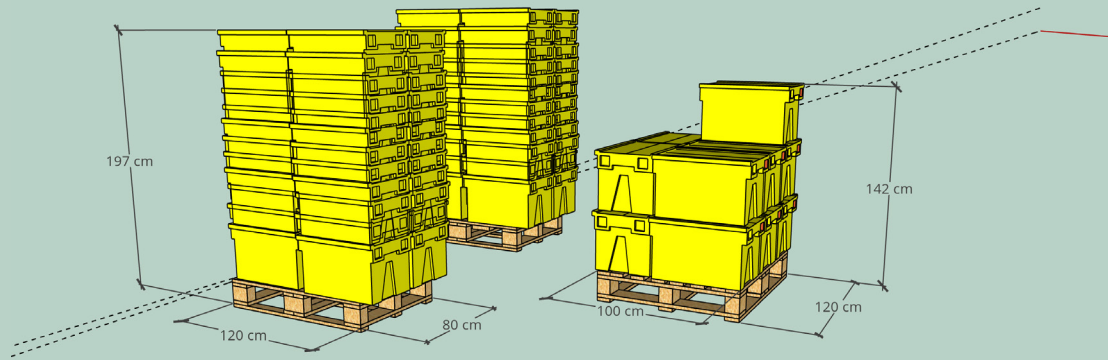

A BRIEF OVERVIEW OF THE SCENOGRAPHY FOR LOL

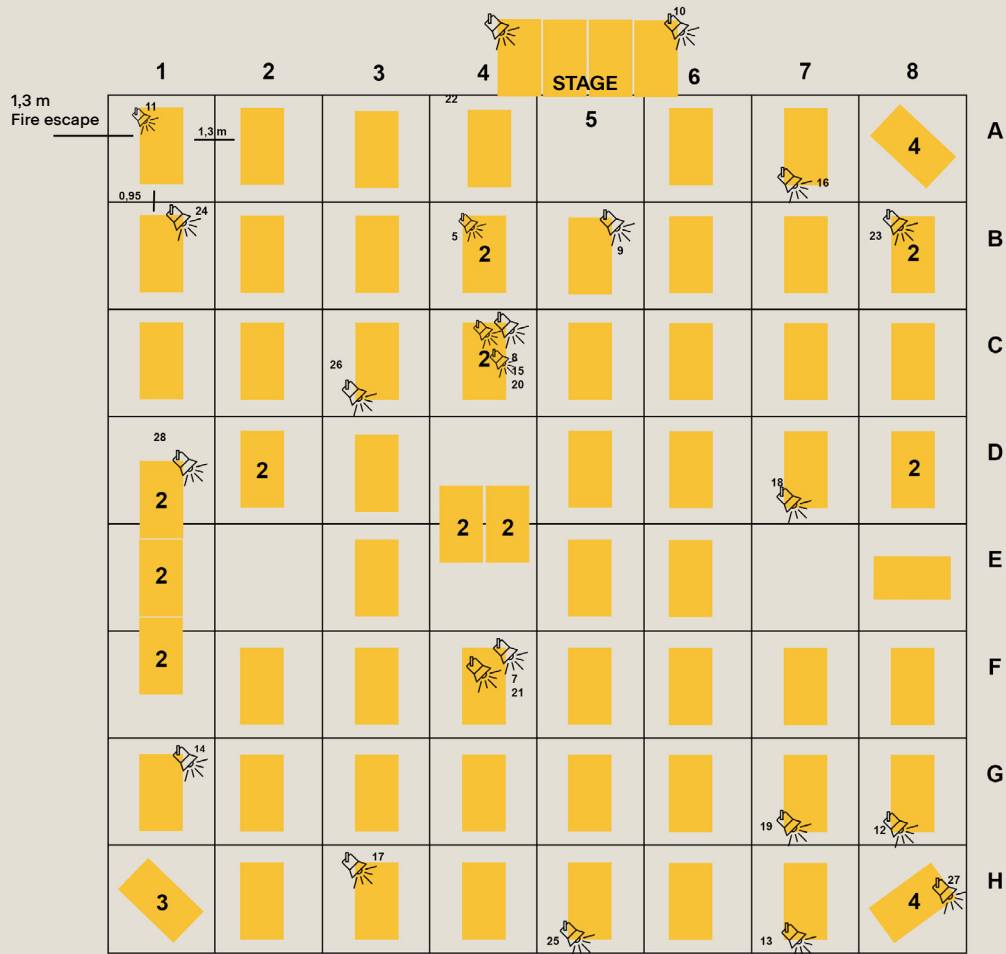

DISMANTLING